

CYLINDER HEAD (II) DISASSEMBLY

B3E011010100E02

1. Disassemble in the order indicated in the table.

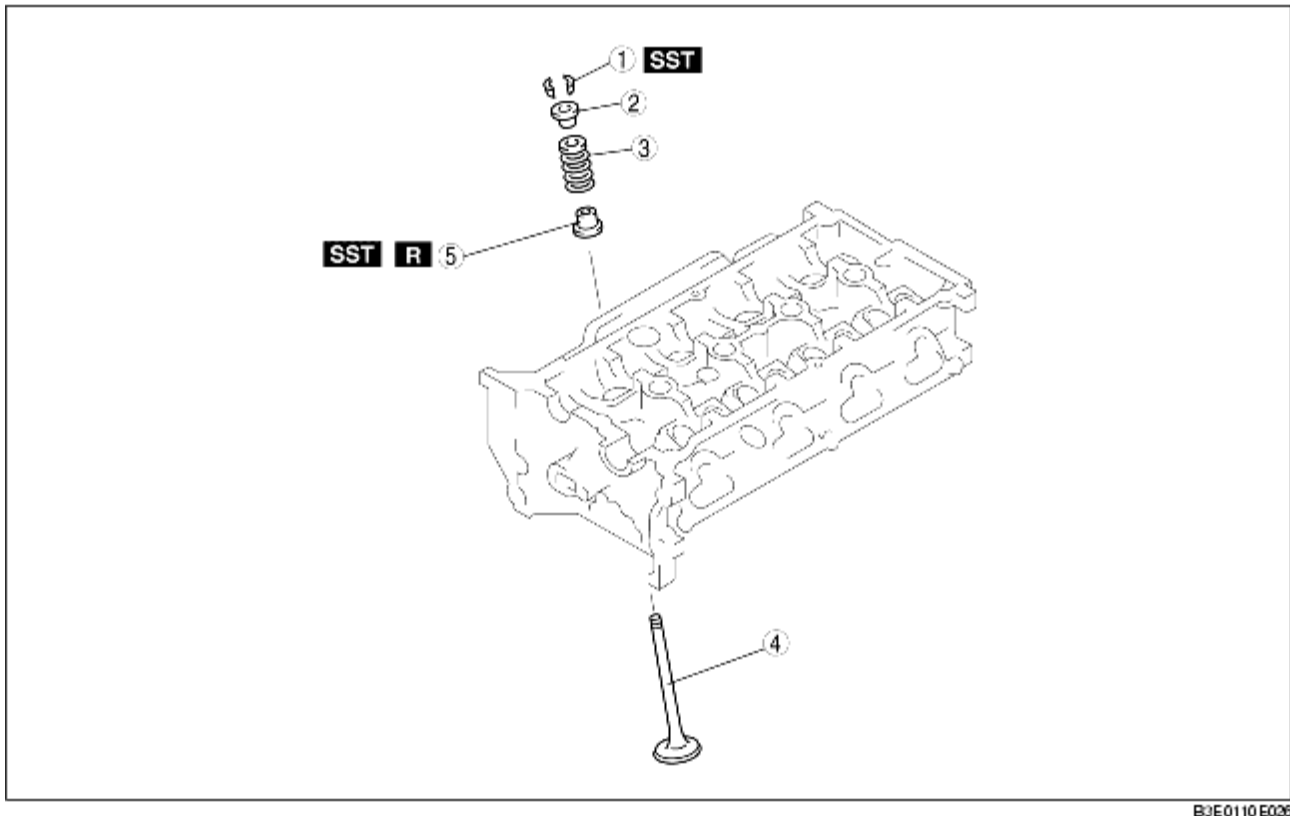

B3E0110 E026

1	Valve keeper (See Valve Keeper Disassembly Note)
2	Upper valve spring seat
3	Valve spring
4	Valve
5	Valve seal (See Valve Seal Disassembly Note)

Valve Keeper Disassembly Note

1. Remove the valve keeper using the **SSTs**.

Valve Seal Disassembly Note

1. Remove the valve seal using the **SST**.

